

Nozzle Number	Orifice Area (sq. in.)	gpm @ 1000 psi	gpm @ 2000 psi	gpm @ 3000 psi	Price
8054	0.00244	2.40	3.40	4.20	\$57.05
8055	0.00282	2.80	3.90	4.80	\$57.05
8056	0.00488	4.90	6.90	8.40	\$57.05
8057	0.0069	7.00	9.70	11.90	\$57.05
8058	0.0138	13.00	19.40	23.80	\$57.05
Nozzle Number	Orifice Area (sq. in.)	gpm @ 1000 psi	gpm @ 2000 psi	gpm @ 3000 psi	gpm @ 3000 psi
8154	0.00244	2.40	3.40	4.20	\$62.09
8155	0.00282	2.80	3.90	4.80	\$62.09
8156	0.00488	4.90	6.90	8.40	\$62.09
8157	0.0069	7.00	9.70	11.90	\$62.09
8158	0.0138	13.00	19.40	23.80	\$62.09
Nozzle Number	Orifice Area (sq. in.)	gpm @ 1000 psi	gpm @ 2000 psi	gpm @ 3000 psi	gpm @ 3000 psi
8254	0.00244	2.40	3.40	4.20	\$62.09
8254R	0.00244	2.40	3.40	4.20	\$62.09
8254M	0.00244	2.40	3.40	4.20	\$62.09
8254M5R	0.00244	2.40	3.40	4.20	\$62.09
8255	0.00282	2.80	3.90	4.80	\$62.09
8255R	0.00282	2.80	3.90	4.80	\$62.09
8255M	0.00282	2.80	3.90	4.80	\$62.09
8255M5R	0.00282	2.80	3.90	4.80	\$62.09
8256	0.00488	4.90	6.90	8.40	\$62.09
8256R	0.00488	4.90	6.90	8.40	\$62.09
8256M	0.00488	4.90	6.90	8.40	\$62.09
8256M5R	0.00488	4.90	6.90	8.40	\$62.09

Standard  
Reverse Thread  
Metric Thread  
Reverse Metric  
Standard  
Reverse Thread  
Metric Thread  
Reverse Metric  
Standard  
Reverse Thread  
Metric Thread  
Reverse Metric

80 series

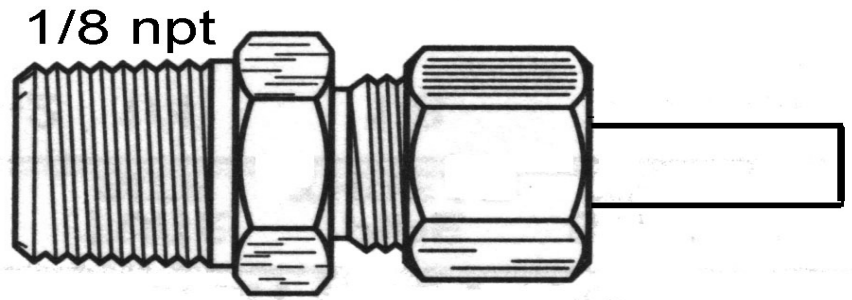

81 series

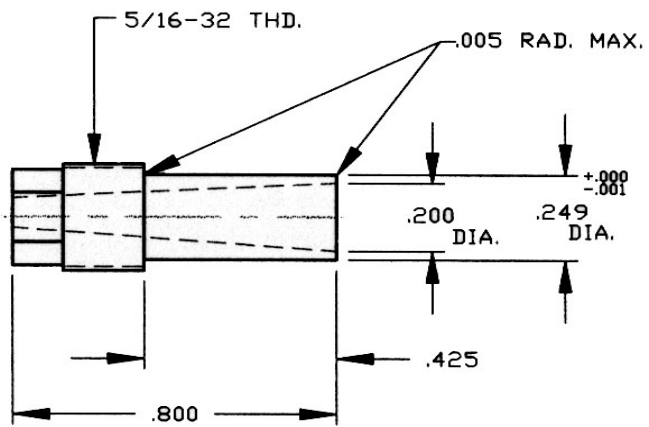

82 series

